

ALTERNATES

- H-1 ALL WORK ASSOCIATED WITH OVERLAY AND SITE IMPROVEMENTS TO THE BUS TRANSFER AND STUDENT PARKING LOTS, SEE SHEET HA-1b
- H-2 ALL WORK ASSOCIATED WITH THE PARKING LOT IMPROVEMENTS TO THE SOUTH OF THE BUS MAINTENANCE FACILITY.
- H-3 ALL WORK ASSOCIATED WITH THE CONSTRUCTION OF A NEW CONCRETE WALKWAY FROM BRIARHEATH AVE. TO WILCOAT DRIVE
- H-4 ALL WORK ASSOCIATED WITH THE RE-TOPPING OF THE EXISTING ASPHALT WALKWAY PATHS.
- H-5 (BY G.C., SEE SHEET HA-2)
- H-6 (BY G.C., SEE SHEET HA-2)
- H-7 OMIT ALL WORK ASSOCIATED WITH THE CONSTRUCTION OF NEW SIDEWALK WHICH LEADS TO NEW EXTERIOR DOORS, SEE DETAIL 4/10-1b

PRIME CONTRACTOR LEGEND

- SC SITE CONTRACTOR
- GC GENERAL CONTRACTOR
- RC RESTORATION CONTRACTOR
- PC PLUMBING CONTRACTOR
- HC HVAC CONTRACTOR
- EC ELECTRICAL CONTRACTOR

KEYNOTE LEGEND

- ① REMOVE EXISTING ASPHALT WALK, FILL VOID TO GRADE W/ TOP SOIL, SEED AND MULCH (BASE BID)
- ② ALT. H-4 OVERLAY EXISTING ASPHALT WALK, SEE DETAIL 5/SD-1 TYPE D1
- ③ NEW PAVEMENT, SEE DETAIL 5/SD-1 TYPE A (SIM.), OVER EXISTING BASE (BASE BID).
- ④ PLACE TOPSOIL FROM WORK AND PARKING EXCAVATION IN LOW AREAS. DO NOT PLACE MORE THAN 4" OF FILL AROUND EXISTING TREE TRUNKS. FINE GRADE TO DRAIN, AND SEED.
- ⑤ EXIST. 4" CLAY TILE
- ⑥ EXIST. 4" PLASTIC TILE
- ⑦ EXIST. 6" CLAY TILE
- ⑧ EXIST. 4" PERFOR DRAIN TILE
- ⑨ EXIST. ELECTRICAL LINE
- ⑩ EXIST SPRINKLER AND WIRES



BEILHARZ ARCHITECTS INCORPORATED
701 1/2 WEST FIRST STREET • DEFIANCE OH IO 43312
TELEPHONE 421-4111
419 782-6211
FAX 419-782-8722

PLOT SCALE
1"=80'
0 40' 80' 120'
FOR SHEET SIZE 22"x34"

ISSUE DATE
1 12-19-97
FOR BIDS

©1997 BEILHARZ ARCHITECTS, INC.

THE OWNER OF THIS PROJECT IS THE BOARD OF SUPERVISORS OF THE AREA SCHOOLS DISTRICT OF NAPOLEON, OHIO. THE ARCHITECT HAS BEEN RETAINED BY THE BOARD OF SUPERVISORS OF THE AREA SCHOOLS DISTRICT OF NAPOLEON, OHIO. THE ARCHITECT'S RESPONSIBILITY IS LIMITED TO THE DESIGN AND CONSTRUCTION OF THE PROJECT AS SHOWN ON THESE PLANS. THE ARCHITECT DOES NOT WARRANT THE ACCURACY OF THE INFORMATION PROVIDED BY THE OWNER. THE ARCHITECT IS NOT RESPONSIBLE FOR ANY OMISSIONS OR ERRORS IN THE INFORMATION PROVIDED BY THE OWNER.

HIGH SCHOOL
NAPOLEON AREA SCHOOLS
701 BRIARHEATH AVENUE
NAPOLEON, OHIO

SITE PLAN
SITE DETAILS

PROJECT: 94-1781M

DRAWN BY: SLB, AWB

CHECKED BY: AWB, JSO

SHEET

HA-1a

PAVING LEGEND

- PAVED PARKING (ALT H-2)
- HEAVY DUTY PAVEMENT (DET 5/SD1 TYPE B) 57,982 SQ.FT.
- CONCRETE APPROACH (DET 4/SD1) 2,271 SQ.FT.
- AREAS GIVEN FOR REFERENCE ONLY. CONTRACTOR SHALL FIELD VERIFY SITE CONDITIONS AND DIMENSIONS

PAVING LEGEND

- PAVED WALKWAYS (ALT H-4)
- NEW OVERLAY (DET 5/SD1 TYPE D1) 28,700 SQ.FT.
- AREAS GIVEN FOR REFERENCE ONLY. CONTRACTOR SHALL FIELD VERIFY SITE CONDITIONS AND DIMENSIONS

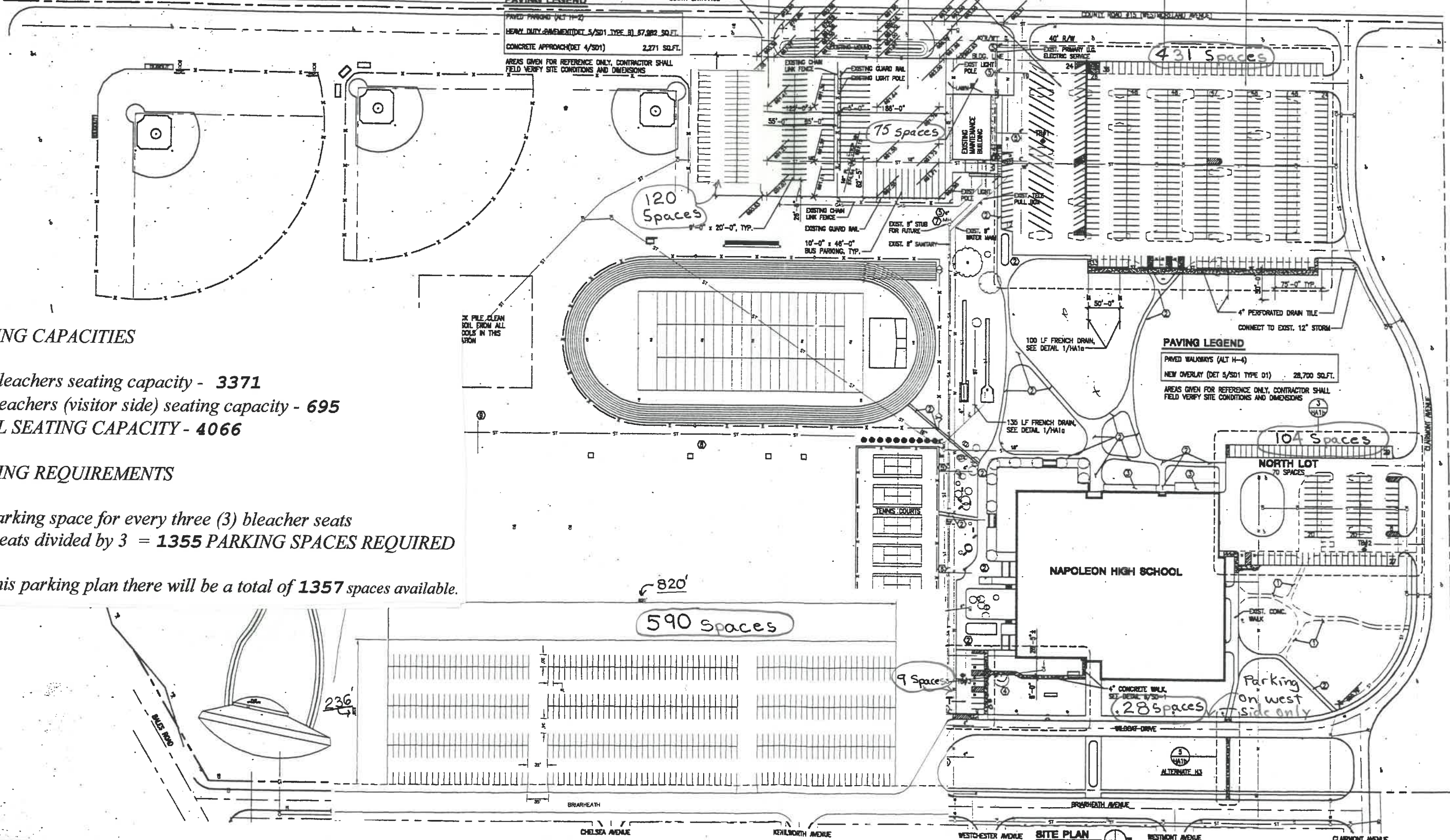

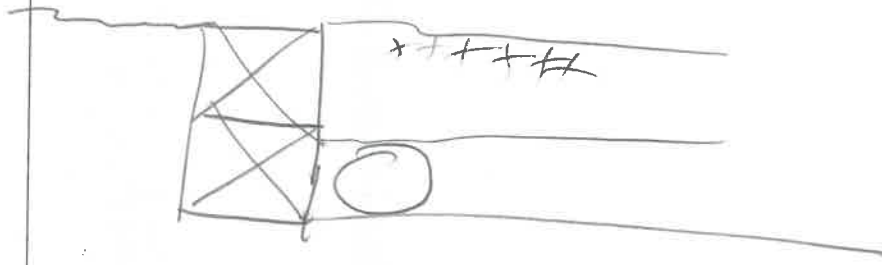
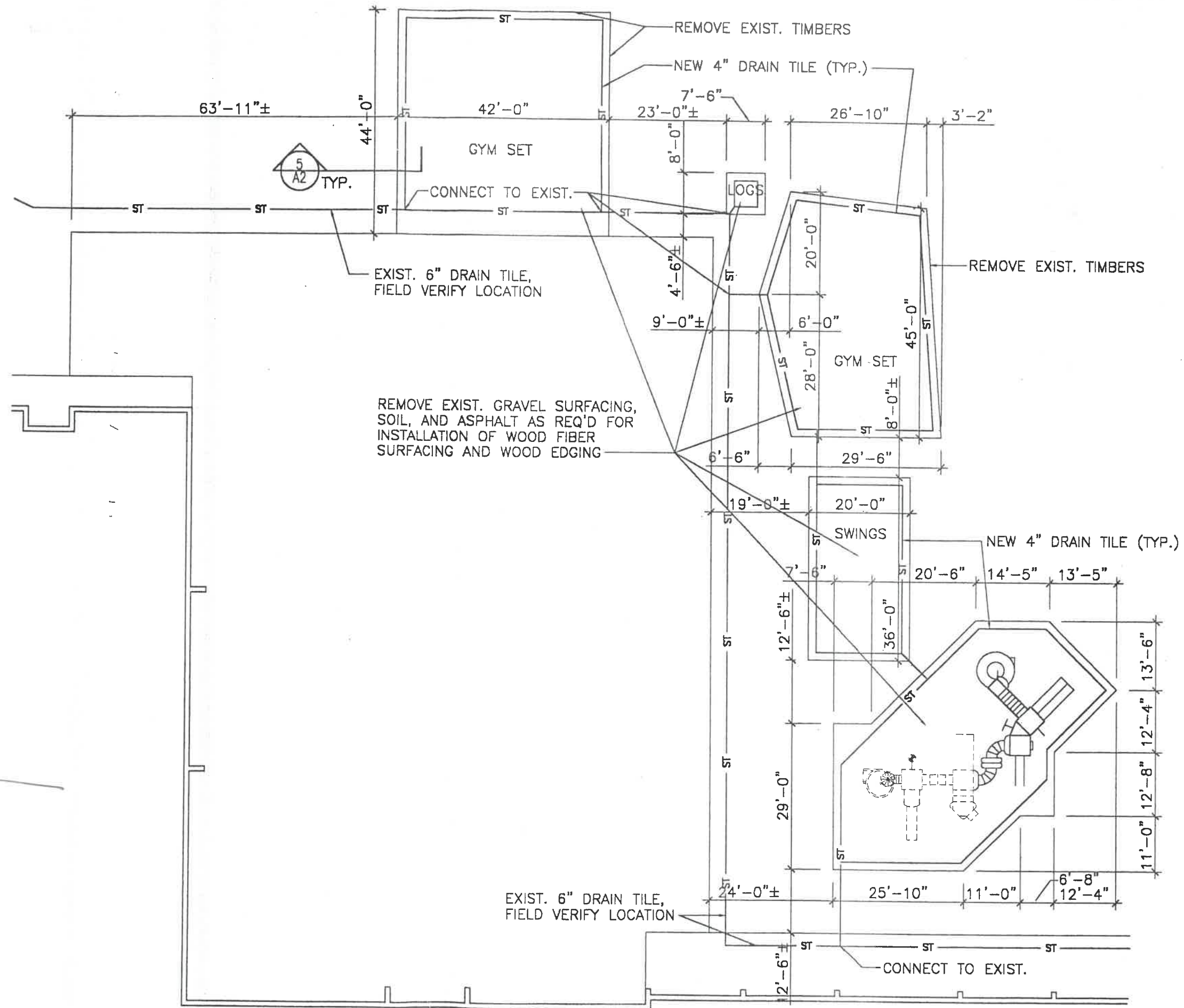

1 PLAYGROUND PLAN
 A6 SCALE: 1"=20'

C.D. BRILLHARDT

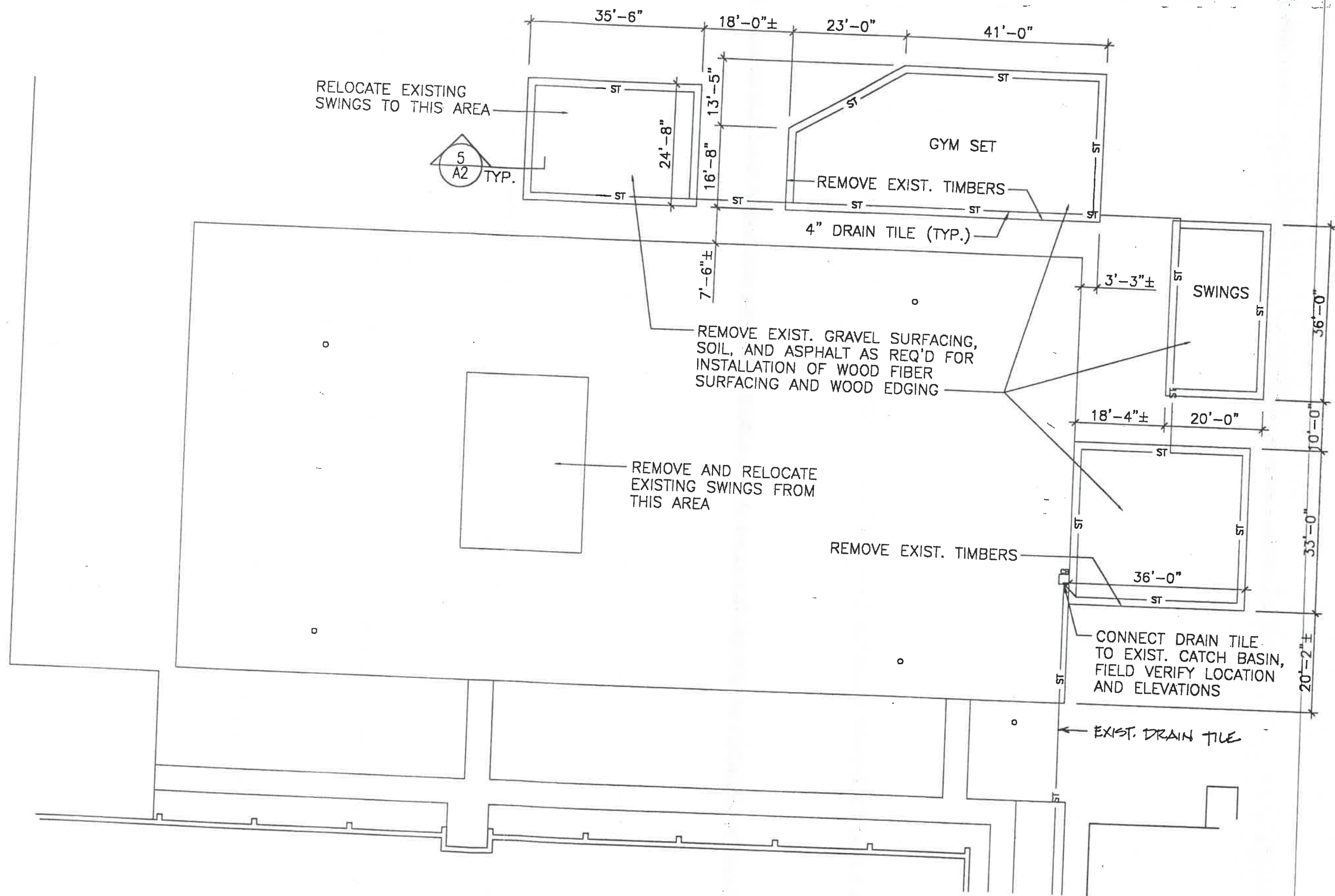

1 PLAYGROUND PLAN
A4 SCALE: 1"=20'

WEST

ADDENDUM #6
10-3-96

CENTRAL

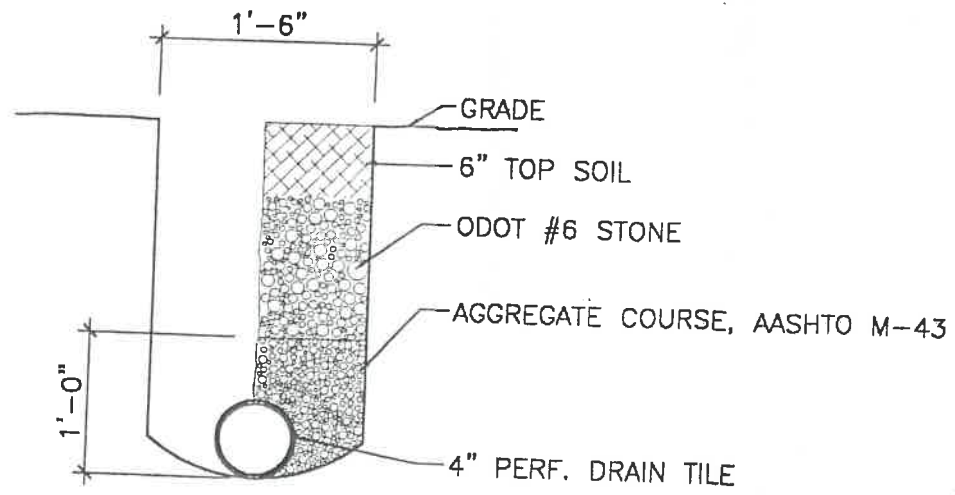

7 FRENCH DRAIN SECTION
 A2 SCALE: NONE

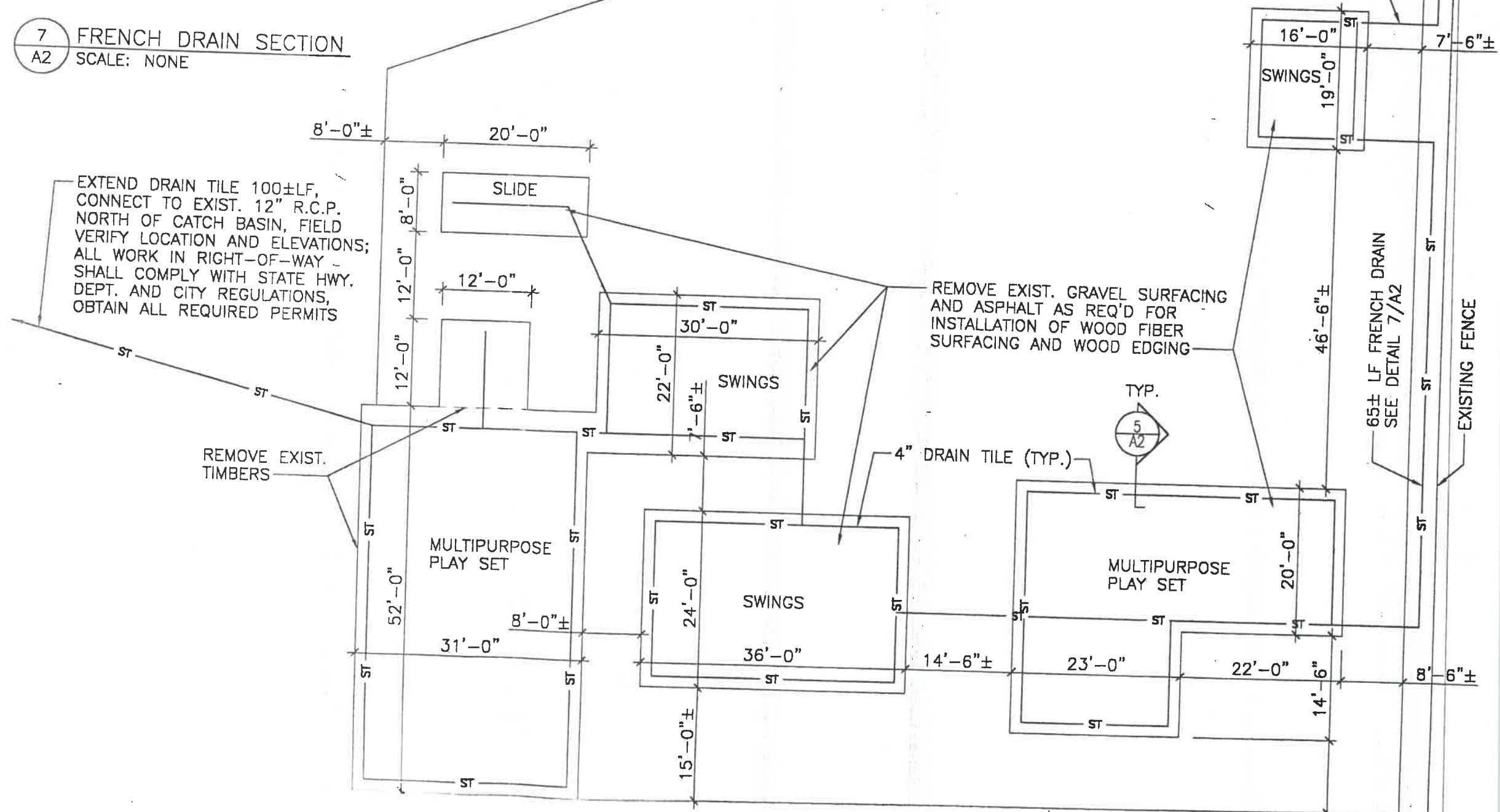

EXTEND DRAIN TILE 100±LF, CONNECT TO EXIST. 12\"/>

REMOVE EXIST. GRAVEL SURFACING AND ASPHALT AS REQ'D FOR INSTALLATION OF WOOD FIBER SURFACING AND WOOD EDGING

40± LF FRENCH DRAIN SEE DETAIL 7/A2

PATCH AND REPAIR PAVING, RESEED GRASS AREAS AS REQ'D FOR DRAIN TILE INSTALLATION (TYP.)

4 PLAYGROUND PLAN
 A1 SCALE: 1/16\"/>

ADDENDUM #6

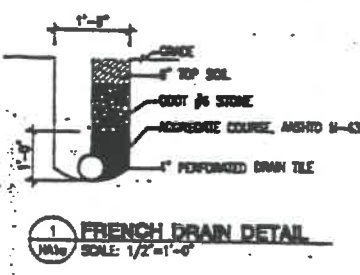

- ALTERNATES**
- H-1 ALL WORK ASSOCIATED WITH OVERLAY AND SITE IMPROVEMENTS TO THE BUS TRANSFER AND STRAIGHT PARKING LOTS, SEE SHEET HA-1a
 - H-2 ALL WORK ASSOCIATED WITH THE PARKING LOT IMPROVEMENTS TO THE SOUTH OF THE BUS MAINTENANCE FACILITY.
 - H-3 ALL WORK ASSOCIATED WITH THE CONSTRUCTION OF A NEW CONCRETE WALKWAY FROM BRIMMEATH AVE. TO WILCOX DRIVE.
 - H-4 ALL WORK ASSOCIATED WITH THE RE-TOPPING OF THE EXISTING ASPHALT WALKWAY PATHS.
 - H-5 (BY G.C., SEE SHEET HA-2)
 - H-6 (BY G.C., SEE SHEET HA-2)
 - H-7 OMIT ALL WORK ASSOCIATED WITH THE CONSTRUCTION OF NEW SIDEWALK WHICH LEADS TO NEW EXTERIOR DOORS, SEE DETAIL 4/H-1b

- PRIME CONTRACTOR LEGEND**
- SC SITE CONTRACTOR
 - GC GENERAL CONTRACTOR
 - RC RESTORATION CONTRACTOR
 - PC PLUMBING CONTRACTOR
 - HC HVAC CONTRACTOR
 - EC ELECTRICAL CONTRACTOR

- KEYNOTE LEGEND**
- 1 REMOVE EXISTING ASPHALT WALK. FILL VOID TO GRADE W/ TOP SOIL, SEED AND MULCH (BASE B0)
 - 2 ALT. H-4, OVERLAY EXISTING ASPHALT WALK. SEE DETAIL 5/SD-1 TYPE D1
 - 3 NEW PAVEMENT, SEE DETAIL 5/SD-1 TYPE A (SHALL OVER EXISTING BASE) (BASE B0)
 - 4 PLACE TOPSOIL FROM WORK AND PARKING EXCAVATION IN LOW AREAS. DO NOT PLACE MORE THAN 4\"/>
- (BY SITE CONTRACTOR, I.D.N.)
- 1 EXIST. 4\"/>
 - 2 EXIST. 4\"/>
 - 3 EXIST. 6\"/>
 - 4 EXIST. 4\"/>
 - 5 EXIST. ELECTRICAL LINE
 - 6 EXIST. SPRINKLER AND WIRES



BEILHARZ ARCHITECTS INCORPORATED
 701 1/2 WEST FIRST STREET • DEFAUCE
 C H I D 4 3 3 1 2
 TELEPHONE N.D.
 4 1 9 • 7 8 2 • 6 2 1 1
 FAX-419-782-8722

PLOT SCALE
 1"=80'
 0 40' 80' 120'
 FOR SHEET SIZE 22"x34"

ISSUE DATE
 12-18-87
 FOR BIDS

©1987 BEILHARZ ARCHITECTS, INC.
 THE NUMBER OF THIS SHEET IS NOT LIMITED BY THE NUMBER OF SHEETS IN A SET. THE NUMBER OF SHEETS IN A SET IS NOT LIMITED BY THE NUMBER OF SHEETS IN A SET. THE NUMBER OF SHEETS IN A SET IS NOT LIMITED BY THE NUMBER OF SHEETS IN A SET.

HIGH SCHOOL
 NAPOLEON AREA SCHOOLS
 701 BRIMMEATH AVENUE
 NAPOLEON, OHIO

SITE PLAN
 SITE DETAILS

PROJECT: 84-1781M

DRAWN BY: S.L.B. AWB

CHECKED BY: AWB, JSD

SHEET

HA-1a

PAVING LEGEND

- PAVED PARKING (DET 11-2)
 - HEAVY DUTY PAVEMENT (DET 5/SD1 TYPE D1) 28,700 SQ.FT.
 - CONCRETE APPROACH (DET 4/SD1) 2,271 SQ.FT.
- AREAS GIVEN FOR REFERENCE ONLY. CONTRACTOR SHALL FIELD VERIFY SITE CONDITIONS AND DIMENSIONS

PAVING LEGEND

- PAVED WALKWAYS (ALT H-4)
 - NEW OVERLAY (DET 5/SD1 TYPE D1) 28,700 SQ.FT.
- AREAS GIVEN FOR REFERENCE ONLY. CONTRACTOR SHALL FIELD VERIFY SITE CONDITIONS AND DIMENSIONS

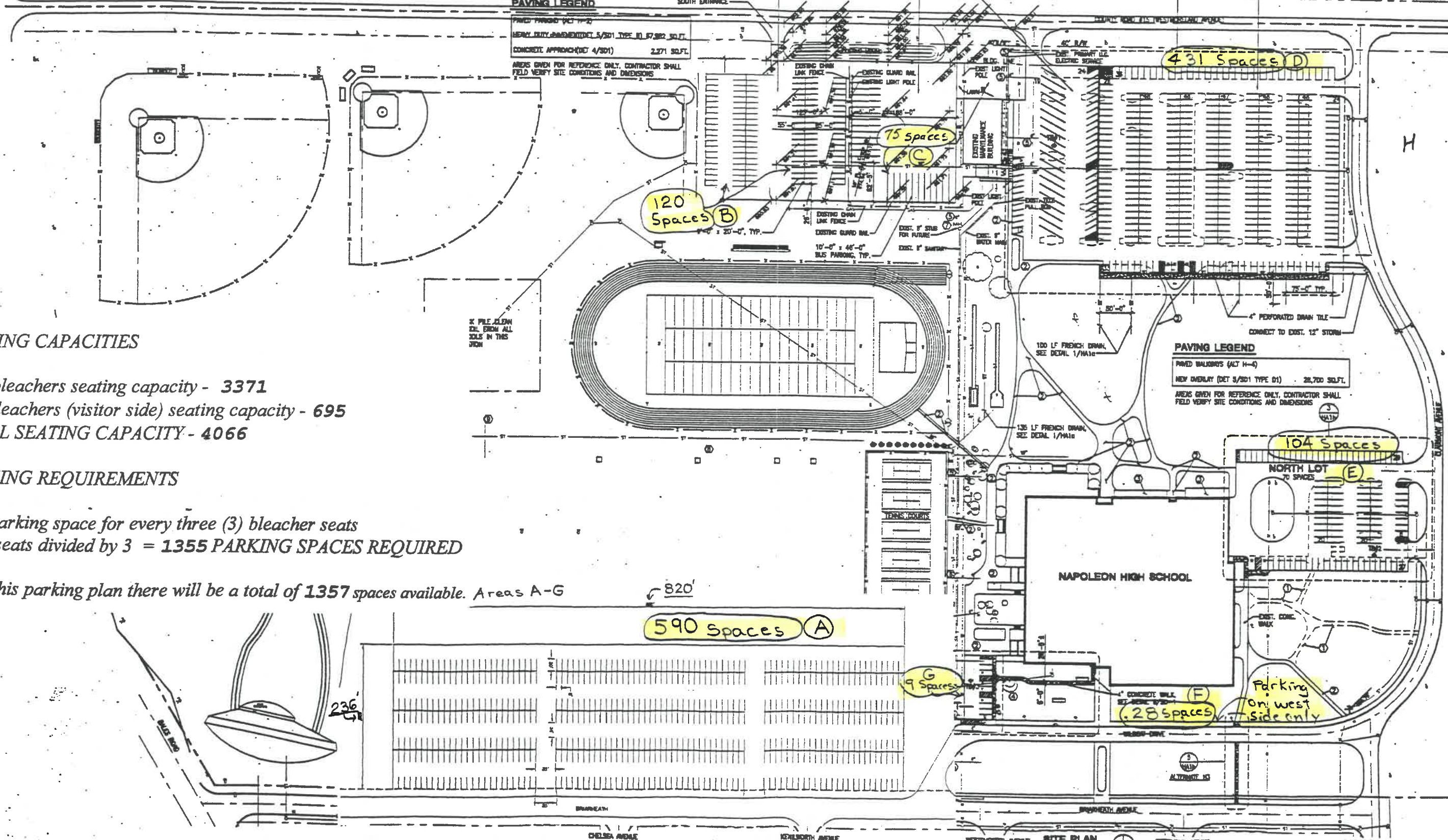

SEATING CAPACITIES

New bleachers seating capacity - 3371
 Old bleachers (visitor side) seating capacity - 695
TOTAL SEATING CAPACITY - 4066

PARKING REQUIREMENTS

One parking space for every three (3) bleacher seats
 4066 seats divided by 3 = **1355 PARKING SPACES REQUIRED**

With this parking plan there will be a total of **1357 spaces available**. Areas A-G

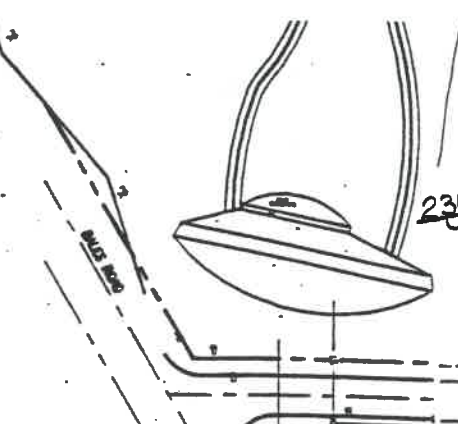

Area A enlargement

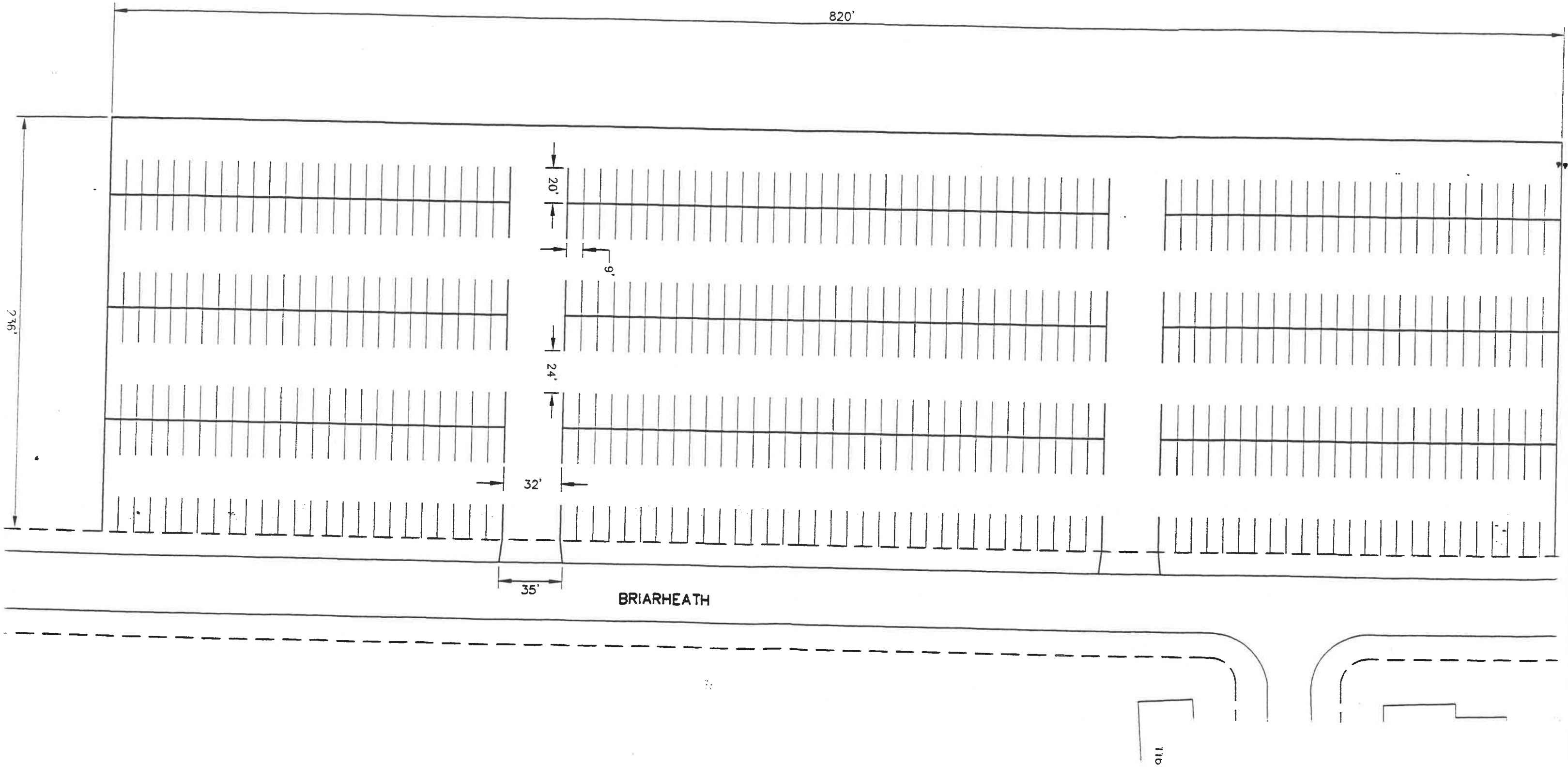

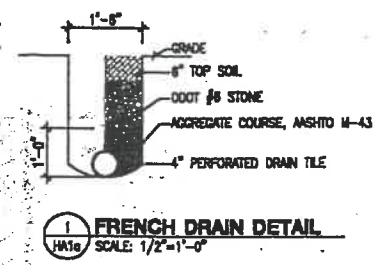

ALTERNATES

- ALT-1 ALL WORK ASSOCIATED WITH OVERLAY AND SITE IMPROVEMENTS TO THE BUS TRANSFER AND STUDENT PARKING LOTS, SEE SHEET HA-1b
- ALT-2 ALL WORK ASSOCIATED WITH THE PARKING LOT IMPROVEMENTS TO THE SOUTH OF THE BUS MAINTENANCE FACILITY.
- ALT-3 ALL WORK ASSOCIATED WITH THE CONSTRUCTION OF A NEW CONCRETE WALKWAY FROM BRIARHEATH AVE. TO WILDCAT DRIVE
- ALT-4 ALL WORK ASSOCIATED WITH THE RE-TOPPING OF THE EXISTING ASPHALT WALKWAY PATHS.
- ALT-5 (BY G.C., SEE SHEET HA-2)
- ALT-6 (BY G.C., SEE SHEET HA-2)
- ALT-7 OMIT ALL WORK ASSOCIATED WITH THE CONSTRUCTION OF NEW SIDEWALK WHICH LEADS TO NEW EXTERIOR DOORS, SEE DETAIL 4/HA-1b

PRIME CONTRACTOR LEGEND

- SC SITE CONTRACTOR
- GC GENERAL CONTRACTOR
- RC RESTORATION CONTRACTOR
- PC PLUMBING CONTRACTOR
- HC HVAC CONTRACTOR
- EC ELECTRICAL CONTRACTOR

KEYNOTE LEGEND

- 1 REMOVE EXISTING ASPHALT WALK, FILL VOID TO GRADE W/ TOP SOIL, SEED AND MULCH (BASE BID)
- 2 ALT. H-4, OVERLAY EXISTING ASPHALT WALK, SEE DETAIL 5/SD-1 TYPE D1
- 3 NEW PAVEMENT, SEE DETAIL 5/SD-1 TYPE A (SIM.), OVER EXISTING BASE (BASE BID).
- 4 PLACE TOPSOIL FROM WORK AND PARKING EXCAVATION IN LOW AREAS. DO NOT PLACE MORE THAN 4" OF FILL AROUND EXISTING TREE TRUNKS. FINE GRADE TO DRAIN, AND SEED.

(BY SITE CONTRACTOR, (L.O.A.))

- 5 EXIST. 4" CLAY TILE
- 6 EXIST. 4" PLASTIC TILE
- 7 EXIST. 8" CLAY TILE
- 8 EXIST. 4" PERF. DRAIN TILE
- 9 EXIST. ELECTRICAL LINE
- 10 EXIST. SPRINKLER AND WIRES



BEILHARZ ARCHITECTS INCORPORATED
 701 1/2 WEST FIRST STREET • DEPT. 2
 OHIO 43312
 TELEPHONE NO. 419-782-6211
 FAX-419-782-8722

PLOT SCALE
 1"=80'
 0 40' 80' 120'
 FOR SHEET SIZE 22"x34"

ISSUE DATE
 12-19-97
 FOR RDS

©1997 BEILHARZ ARCHITECTS, INC.
 THE CONTENT OF THIS DRAWING IS NOT GUARANTEED TO BE COMPLETELY ACCURATE. THE USER SHALL BE RESPONSIBLE FOR VERIFYING THE ACCURACY OF THE INFORMATION AND DATA PROVIDED HEREON. THE USER SHALL BE RESPONSIBLE FOR OBTAINING ALL NECESSARY PERMITS AND APPROVALS FROM THE APPROPRIATE AGENCIES. THE USER SHALL BE RESPONSIBLE FOR OBTAINING ALL NECESSARY PERMITS AND APPROVALS FROM THE APPROPRIATE AGENCIES. THE USER SHALL BE RESPONSIBLE FOR OBTAINING ALL NECESSARY PERMITS AND APPROVALS FROM THE APPROPRIATE AGENCIES.

HIGH SCHOOL
 NAPOLEON AREA SCHOOLS
 701 BRIARHEATH AVENUE
 NAPOLEON, OHIO

SITE PLAN
SITE DETAILS

PROJECT: 94-1781M

DRAWN BY: SLB, AWB

CHECKED BY: AWB, JSD

SHEET

HA-1a

OF 8

PAVING LEGEND

PAVED PARKING (ALT H-2)
 HEAVY DUTY PAVEMENT (DET. 5/SD1 TYPE B) 97,882 SQ. FT.
 CONCRETE APPROACH (DET 4/SD1) 2,271 SQ. FT.
 AREAS GIVEN FOR REFERENCE ONLY. CONTRACTOR SHALL FIELD VERIFY SITE CONDITIONS AND DIMENSIONS

PAVING LEGEND

PAVED WALKWAYS (ALT H-4)
 NEW OVERLAY (DET 5/SD1 TYPE D1) 28,700 SQ. FT.
 AREAS GIVEN FOR REFERENCE ONLY. CONTRACTOR SHALL FIELD VERIFY SITE CONDITIONS AND DIMENSIONS

ALTERNATE H2:
 PAVE EXISTING STONE PARKING AREA WITH HEAVY DUTY PAVEMENT (DETAL 5/SD-1 TYPE B), INSTALL 4" CATCH BASINS AND CONNECT TO EXIST. 18" STORM LINE. FIELD VERIFY EXISTING DIMENSIONS AND GRADES, STRIPE AS INDICATED. NEW PAVING TO SLOPE 4% TO NEW CATCH BASINS.

UNDER ALTERNATE, CONSTRUCT CONCRETE APPROACH SIMILAR TO 4/SD-1 AT NORTH AND SOUTH ENTRANCE

BUS TRANSFER LOT
 19 BUSES
 38 CARS

STUDENT LOT
 ALTERNATE H1
 361 SPACES

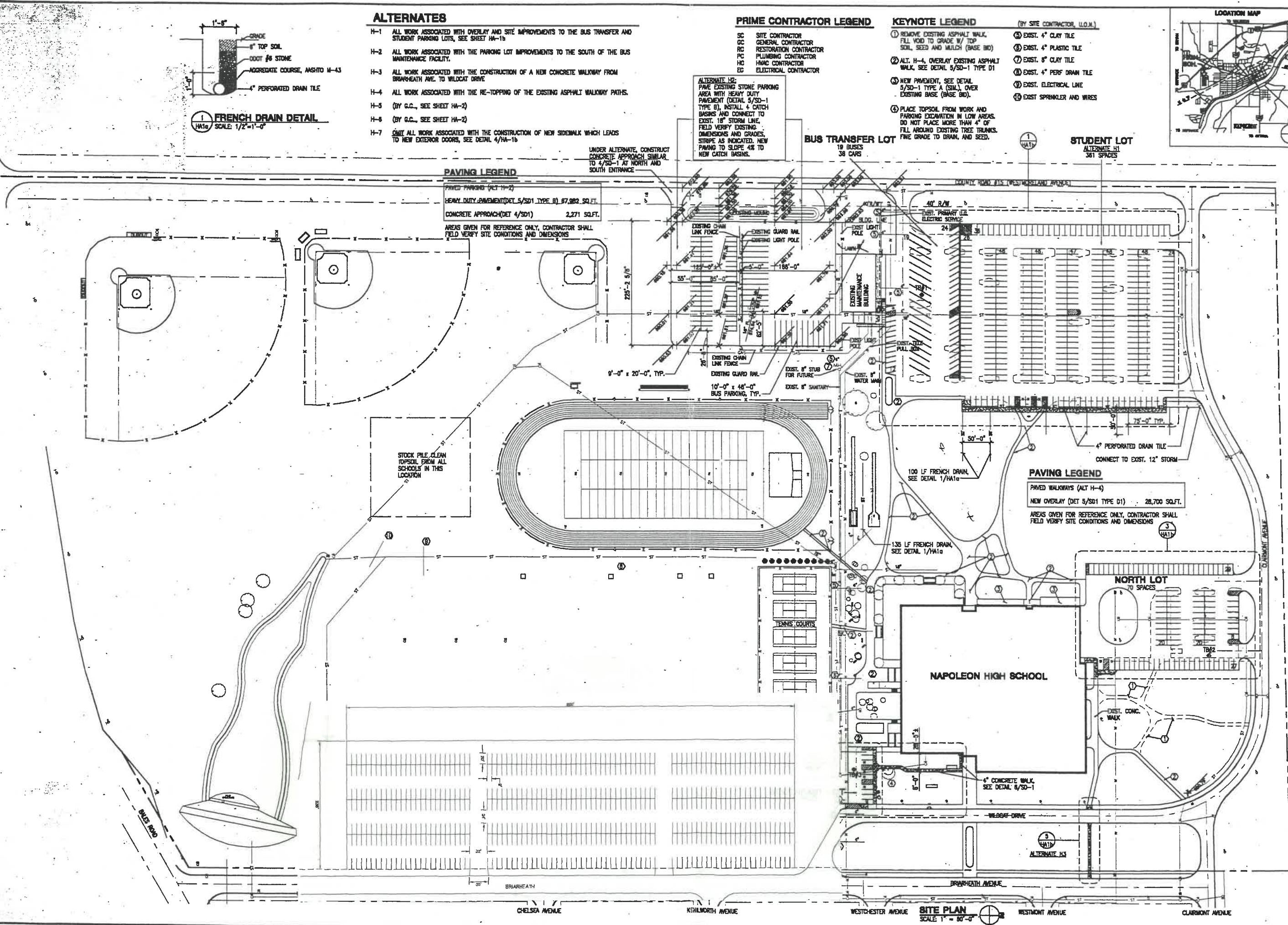

SITE PLAN
 SCALE: 1"=80'-0"